

# SHARP

Be Original.

PN-Q901  
PN-Q801  
PN-Q701  
PN-Q601  
LCD MONITOR

Grab the Attention of Viewers for  
a New Level of Engagement



# Affordable, Professional LCD Monitors to Engage Audience in a Variety of Environment

The 90" class (90 <sup>1</sup>/<sub>64</sub>" diagonal), 80" class (80" diagonal), 70" class (69 <sup>1</sup>/<sub>2</sub>" diagonal) and 60" class (60 <sup>3</sup>/<sub>32</sub>" diagonal) Sharp professional LCD monitors combine full-HD image quality and a stylish, thin profile for the ultimate viewing experience. PN-Q901, PN-Q801, PN-Q701 and PN-Q601 professional LCD monitors are perfect for retail settings, waiting rooms and other business locations that need to grab the attention of viewers for a new level of engagement.



## B2B Features for Ultimate Control

Business owners can easily manage the functionality of the PN-Q901/Q801/Q701/Q601 professional LCD monitors due to their many user-friendly features. They include a powerful RS-232C command set, which permits flexible remote control capabilities from connected devices. In addition, displaying still images or videos couldn't be easier with the USB port. Business owners will also appreciate optimal content control with added lockout features including IR Remote, Power, Volume, Input, OSD disable and LED disable. All this with 16/7 reliability.

## Superb Image Quality

The PN-Q901/Q801/Q701/Q601 professional LCD monitors have cutting-edge picture technology that delivers amazing detail, gorgeous color depth and consistent image quality. The advanced pixel structure of the panel enables stunning 4 million : 1 dynamic contrast for deeper blacks and whiter whites.



PN-Q801



## Bigger Screen, Slimmer Bezel

Fit more screen in less space with the PN-Q901/Q801/Q701/Q601 professional LCD monitors. Streamlined for a pleasing appearance and minimal protruding parts, the PN-Q901/Q801/Q701/Q601 weighs only 64/50/34/24 kg. A bezel thickness\* of only 26.34/15.53/11.15/11.11 mm makes for easy placement in offices, public places, stores and other commercial establishments. The PN-Q901 professional LCD monitor also has a 44 percent greater viewing area and the PN-Q801 has a 14 percent greater viewing area than a 75" class screen. The PN-Q701 has a 14 percent greater viewing area than a 65" class screen and the PN-Q601 has a 20 percent more viewing area than a 55" class screen.

\* PN-Q901: 26.34 (right/left), 29.5 (top), 35 mm (bottom\*\*)   
 PN-Q801: 15.53 (right/left/top), 20.13 mm (bottom\*\*)   
 PN-Q701: 11.15 (right/left), 10.85 (top), 15.65 mm (bottom\*\*)   
 PN-Q601: 11.11 (right/left), 10.81 (top), 15.61 mm (bottom\*\*)   
 \*\* Excluding protruding indicator panel

## Enhanced Connectivity

Three (3) HDMI™ inputs let you connect multiple HD sources including digital signage and cable boxes. A powerful RS-232C command set permits flexible remote control capabilities from connected devices. A built-in USB port lets you present a variety of digital content. Simply insert a USB memory device into the monitor and the built-in media player starts playing your photos, music and videos, right away.

## Built-in Speakers for Powerful Audio

Powerful 20 W audio features high fidelity so all of your scenes sound as breathtaking as they look.



PN-Q901

## Specifications

Model Name	PN-Q901	PN-Q801	PN-Q701	PN-Q601
Installation	Landscape			
LCD Panel	90" class (90 1/4" [228.66 cm] diagonal) UV²A*¹ LCD	80" class (80" [203.22 cm] diagonal) UV²A*¹ LCD	70" class (69 1/2" [176.56 cm] diagonal) UV²A*¹ LCD	60" class (60 3/32" [152.66 cm] diagonal) UV²A*¹ LCD
	1,920 x 1,080 pixels			
	1.07 billion colours			
	1.038 x 1.038 mm	0.9225 x 0.9225 mm	0.8015 x 0.8015 mm	0.693 x 0.693 mm
	350 cd/m²			
	5,000 : 1			
	4,000,000 : 1			
	176°/176° (CR≥10)			
	1,992.96 x 1,121.04 mm (78 15/32" x 44 3/64")	1,771.20 x 996.30 mm (69 47/64" x 39 15/64")	1,538.88 x 865.62 mm (60 19/32" x 34 7/32")	1330.56 x 748.44 mm (52 25/64" x 29 15/32")
	4 ms (grey to grey, avg.)			
	LED, full array		LED, edge lit	
Computer Input	Video	HDMI, Analog RGB		
	Synchronisation	Horizontal/vertical separation (TTL: positive/negative)		
	Plug & Play	VESA DDC2B		
Video Colour System	NTSC-M/PAL-N/PAL-M			
Input Terminals*³	HDMI x 3, Mini D-sub 15-pin x 1, Component Video RCA (Y, Cb/Pb, Cr/Pr) x 1, Composite Video RCA pin x 2, RCA pin (L/R) x 2, 3.5 mm-diameter mini stereo jack x 1, RS-232C x 1, USB x 1			
Output Terminals*³	Audio: RCA pin (L/R) x 1, Digital audio output (optical) x 1			
Input/Output Terminals*³	Ethernet RJ-45 x 1			
Speaker Output	10 W + 10 W			
Power Supply	110 – 240 V AC 50/60Hz			
Power Consumption	290 W	300 W	180 W	150 W
Operating Temperature	0°C to 40°C			
Dimensions (W x D x H) (approx.) (display only)	2,054 x 116 x 1,211 mm (80 7/8" x 4 37/64" x 47 11/16")	1,816 x 114 x 1,055 mm (71 1/2" x 4 1/2" x 41 35/64")	1,563 x 87 x 910 mm (61 35/64" x 3 7/16" x 35 53/64")	1,355 x 86 x 792 mm (53 23/64" x 3 25/64" x 31 3/16")
Weight (approx.) (display only)	64 kg (141.1 lbs)	50 kg (110.2 lbs)	34 kg (75 lbs)	24 kg (52.9 lbs)

\*¹ UV²A stands for Ultraviolet-induced Multi-domain Vertical Alignment, a photo-alignment technology that ensures uniform alignment of liquid crystal molecules. \*² Brightness depends on input mode and other picture settings. Brightness level will decrease slightly over the lifetime of the product. Due to the physical limitations of the equipment, it is not possible to maintain a precisely constant level of brightness. \*³ Use a commercially available connection cable for PC and other video connections.

## Dimensions

(PN-Q901)

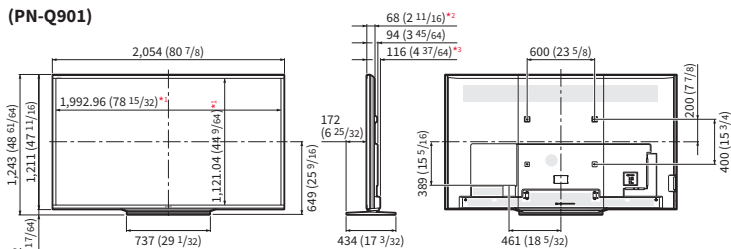

(PN-Q701)

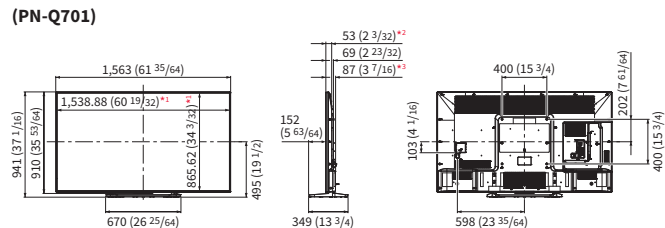

(PN-Q801)

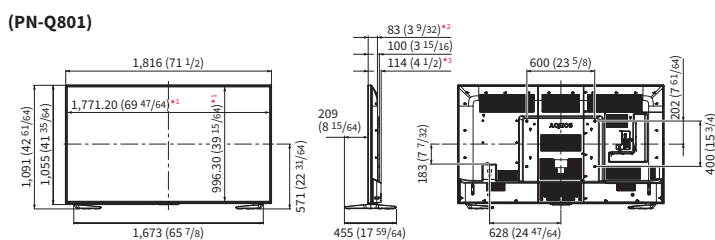

(PN-Q601)

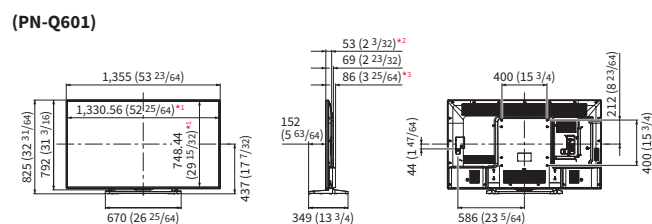

Units: mm (inch)

\*¹ Active area, \*² Thinnest part, \*³ Including projecting parts

The terms HDMI and HDMI High-Definition Multimedia Interface, and the HDMI Logo are trademarks or registered trademarks of HDMI Licensing Administrator, Inc. in the United States and other countries. All other brand names and product names may be trademarks or registered trademarks of their respective owners. All screen images appearing in this brochure are simulated. Design and specifications are subject to change without prior notice.



Distributed by:

# SHARP

SHARP BUSINESS SYSTEMS INDIA PVT LTD  
3rd Floor, BITS Tower, Plot No 9,  
Sector-125, Noida U.P

©SHARP CORPORATION (MAR. 2017)